

Multi row cylindrical roller bearings (outer assy)

R 315189 AF2DS1ZB/4B1/SSE

R00

GR011020

MA011020

Main boundary dimensions (mm)

Fw	179
D	230
C	168

Technical data

Basic load ratings (kN)	Dyn.	C_r	1100
	Stat.	C_{0r}	2180
Mass (kg)			16,8
Cage material			Steel
Min chamfer dimensions (mm)	r₁	-	
	r₂	-	
	r₃	2,0	
	r₄	2,0	
Precision class			P6
e			-
Bearing clearance (mm)			-

Technical notes

- Two outer rings each with three integral ribs
- Two double pronged reinforced machined steel cages guided on rollers
- Optimized roller profile for improved load distribution. Crowned raceways
- Annular groove and lubrication holes in each outer ring
- Scallop in side faces of outer rings
- Bainite hardened outer rings and rolling elements
- Bearing rings heat stabilized for operating temperatures up to 200 °C. Marked zones

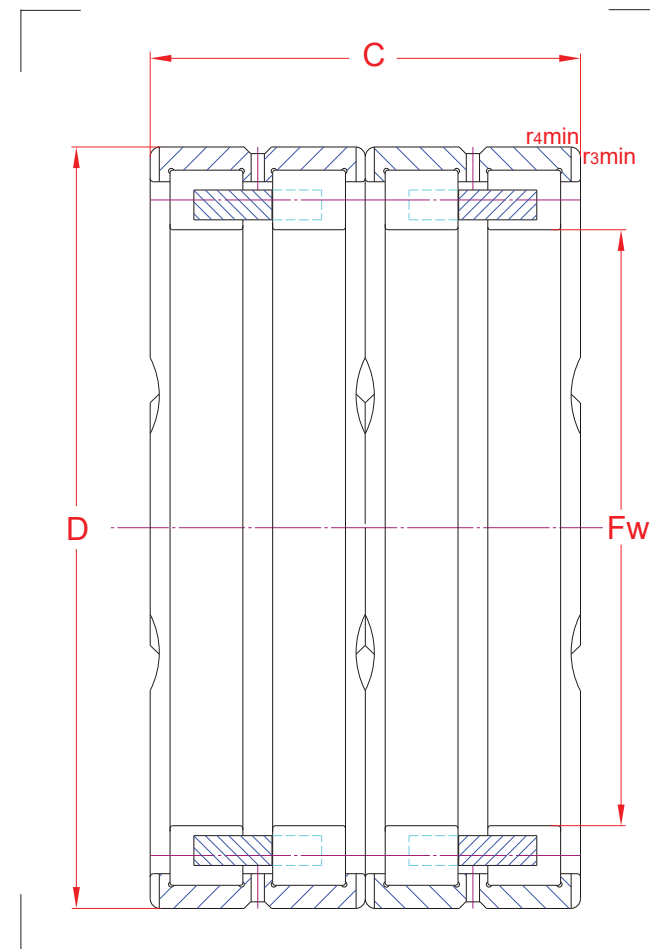

The sketch is for reference only and may not be representative or indicative of the actual product. Sketch scale is free.

Also refer to RKB Affidavit of Conformance for related compliance to International Standards.

Every care has been taken to ensure the accuracy of the information in the present drawing, but no liability can be accepted for any errors or omissions contained herein, or in case losses and/or damages (direct, indirect, consequential) should occur.

RKB Bearing Industries reserves the right of any amendment without notice.