

Double row angular contact ball bearings

305183 P6AS1/S

R00

GR210521

MA100521

Main boundary dimensions (mm)

d	160
D	240
B	76
C	76

Technical data

Basic load ratings (kN)	Dyn.	C_r	231,66
	Stat.	C_{0r}	331,00
Mass (kg)			11,7
Cage material			Brass
Min chamfer dimensions (mm)	r₁		2,1
	r₂		2,1
	r₃		2,1
	r₄		2,1
Precision class			P6
e			1,14
Bearing clearance (mm)			0,060/0,120

Technical notes

- Reference speed 2000 rpm
- Limiting speed 2600 rpm
- Bearing with a 40° contact angle
- Scallop in inner side faces of outer rings
- Bearing rings heat stabilized for operating temperatures up to 200 °C
- Application optimized bearing

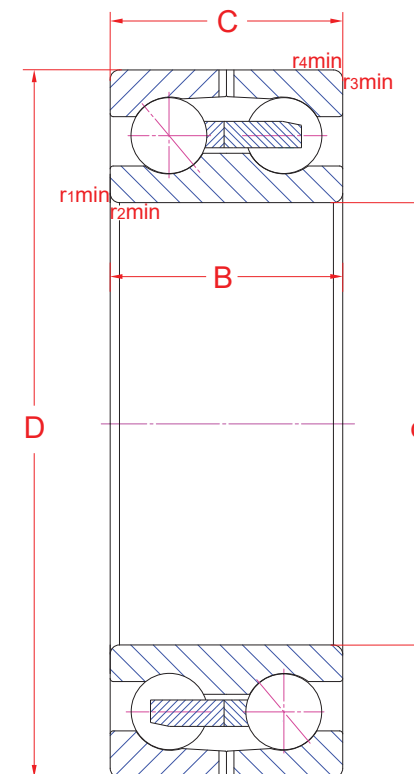

The sketch is for reference only and may not be representative or indicative of the actual product. Sketch scale is free.

Also refer to RKB Affidavit of Conformance for related compliance to International Standards.

Every care has been taken to ensure the accuracy of the information in the present drawing, but no liability can be accepted for any errors or omissions contained herein, or in case losses and/or damages (direct, indirect, consequential) should occur.

RKB Bearing Industries reserves the right of any amendment without notice.